

Hills on Fire

By Joe Stevens & Keaton Wooden

UF School of Theatre and Dance &
Tilted Wildmills Theatricals

Directed by Ryan Hope Travis

Sound Design by Jesse Desrosiers

Asst. Sound Designer: Zixia Li

Sound Design Advisor: Jing Zhao

Scale: 1/4" = 6'

As of: 5/20/19

Speaker Plot

Deck

*Danley speakers are 6" in every dimension.

*X-Array speakers hung from the grid are pointed down at an angle of 45°.

*Danley speakers are placed under floorboards of the set facing the audience directly so that sound can escape from the sides.

*Cable lengths include vertical distances.

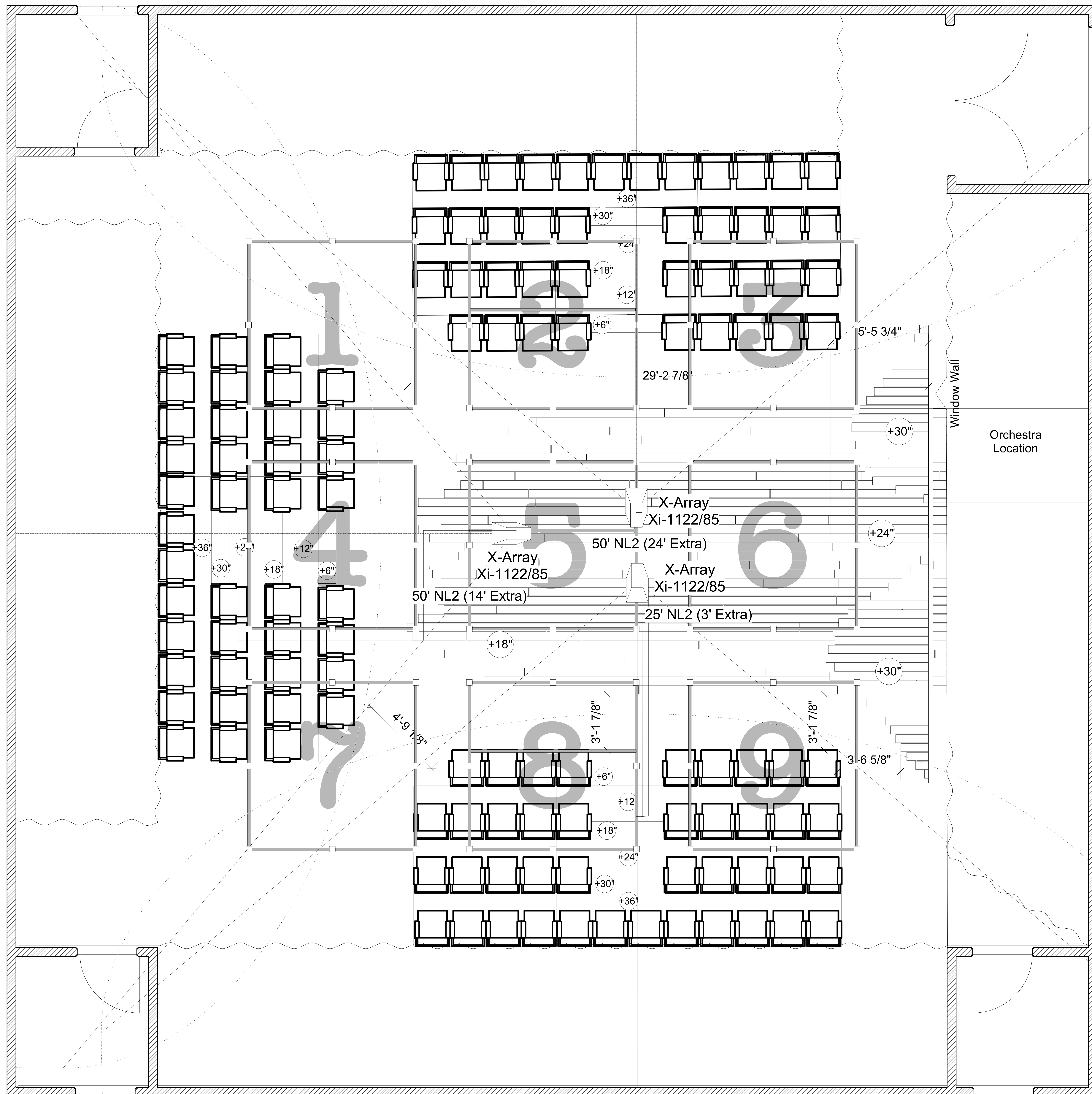

Hills on Fire

By Joe Stevens & Keaton Wooden

UF School of Theatre and Dance & Tilted Wildmills Theatricals

Directed by Ryan Hope Travis

Sound Design by Jesse Desrosiers

Asst. Sound Designer: Zixia Li

Sound Design Advisor: Jing Zhao

Scale: 1/4" = 6'

As of: 5/20/19

Speaker Plot

Grid

*Danley speakers are 6" in every dimension.

*X-Array speakers hung from the grid are pointed down at an angle of 45°.

*Danley speakers are placed under floorboards of the set facing the audience directly sound that sound can escape from the sides.

*Cable lengths include vertical distances.

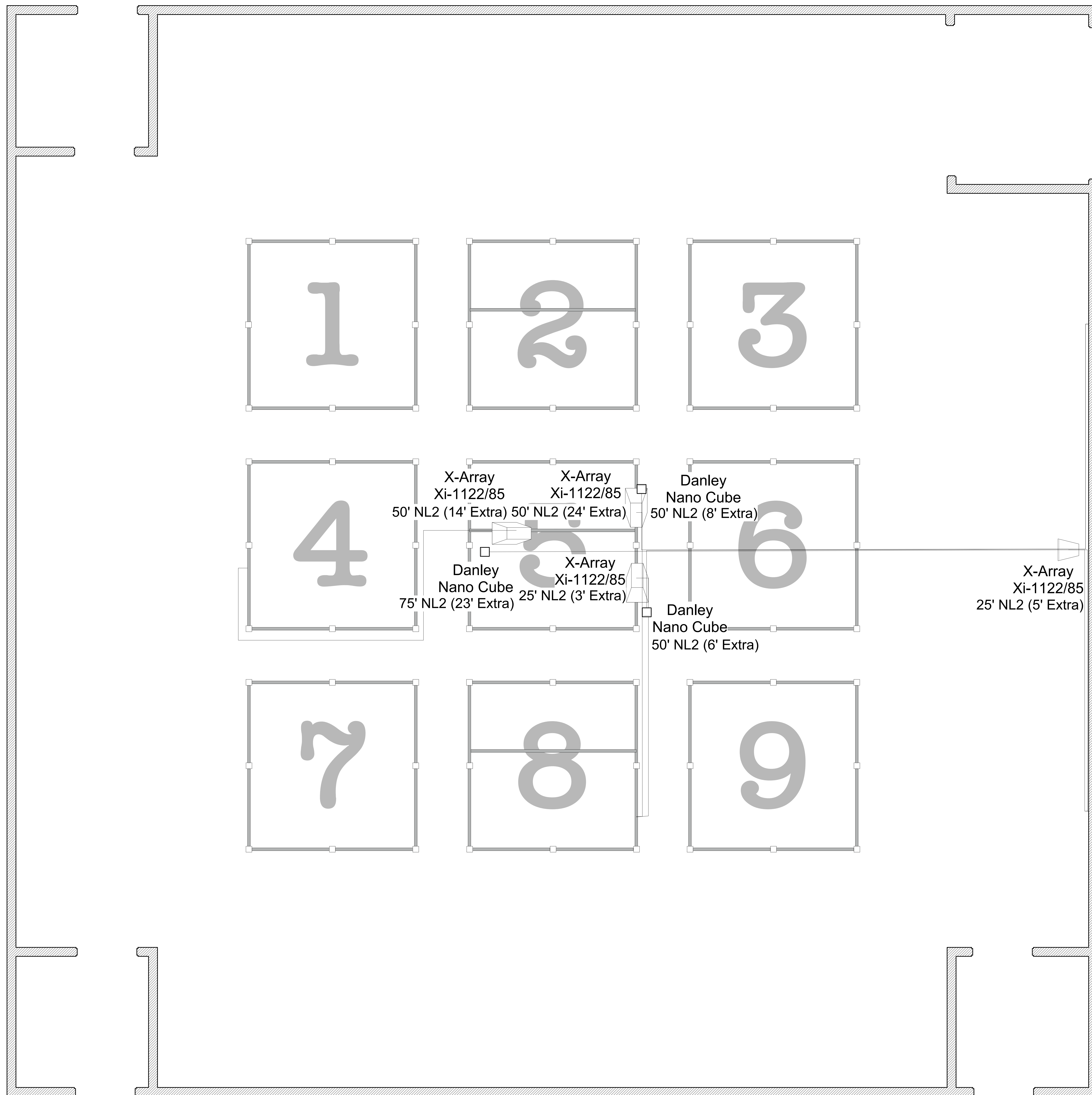

Hills on Fire

By Joe Stevens & Keaton Wooden

UF School of Theatre and Dance & Tilted Wildmills Theatricals

Directed by Ryan Hope Travis

Sound Design by Jesse Desrosiers

Asst. Sound Designer: Zixia Li
 Sound Design Advisor: Jing Zhao

Scale: 1/4" = 6'

As of: 5/20/19

Speaker Plot

Deck

Grid

*Danley speakers are 6" in every dimension.

*X-Array speakers hung from the grid are pointed down at an angle of 45°.

*Danley speakers are placed under floorboards of the set facing the audience directly sound that sound can escape from the sides.

*Cable lengths include vertical distances.